

# The Quinn Series

BLMQ - Wall Mount Linear

Project	Date
Part	Type



## About The Quinn Series

The BLMQ is an LED linear fixture designed for wall mounting. It is well suited for indoor use where high efficiency, task lighting is required. Its narrow design and modern profile make it an ideal fixture for task lighting applications.

## Specifications

Supported Voltage	120-277V, 120-347V, 347V, 480V
Available Sizes	2', 3', 4'
Lifetime	L70 of 90,000+ hours
Operating Temperature	-20°C/+25°C
Lumens	Lumen output/ft ranging from 2.5L (2500lm) to 11.5L (11500lm)
CCT	2700K, 3000K, 3500K, 4000K, 5000K, 6500K
CRI	80+ standard, 90+ and 95+ available
Dimming	0-10V Standard

## Approvals

- ETL Listed
- Dry and Damp Environment Rated
- Designed and Manufactured in Canada

## Warranty

- 5 Year Comprehensive, 10 Year LED

# The Quinn Series

BLMQ - Wall Mount Linear

Linear Lighting by



## Ordering Information

Fill in the fields below with your product selections. If you need help with this section, [contact your local sales professional](#).

**BLMQ** - **4'** - **2.5** - **2.5** - **835** - **347** - **L53** - **R17**  
 Fixture Series      Lumens (Up)      CRI & Colour Temp      Lens      Divider

1	2	3	4	5	6
<b>BLMQ</b>					
Series	Lumens (UP)		Lumens (DOWN)		Voltage
BLMQ	2'-1L	1,000lm	2'-1L	1,000lm	UNV 120-277V
	2'-1.5L	1,500lm	2'-1.5L	1,500lm	347 347V
	2'-2L	2,000lm	2'-2L	2,000lm	UN3 120-347V
	3'-1L	1,000lm	3'-1L	1,000lm	480 480V
	3'-1.5L	1,500lm	3'-1.5L	1,500lm	
	3'-2L	2,000lm	3'-2L	2,000lm	
	4'-2L	2,000lm	4'-2L	2,000lm	
	4'-2.5L	2,500lm	4'-2.5L	2,500lm	
	4'-3L	3,000lm	4'-3L	3,000lm	
	4'-3.5L	3,500lm	4'-3.5L	3,500lm	
	4'-4L	4,000lm	4'-4L	4,000lm	

## Options

### Down Light

BLANK | Not required

### Lenses

L53 | Opal Lens

### Divider

BLANK | Not required  
R17 | Up/Down Light Divider

### Dimming

B11 | 0-10V Dimming Leads  
B12 | Line voltage dimming  
B27 | Dim-to-off Driver  
B\*\* | Other Options Available\*

### Motion Sensor

W26 | Photocell Motion Sensor

### Emergency Driver

B17 | UL924 10W Battery Back-up

### Switches

S1 | On/Off Pull Chain  
S2 | 3-Way Pull Chain

### Finish

BLANK | Standard Matte White  
C5 | Matte Black  
CUSTOM\* | Custom Colour Choice

### Packaging

BLANK | Individually Boxed on Pallets  
P0 | Bulk Packaging

### Warranty

CL7 | 10-Year Comprehensive Warranty Upgrade

# The Quinn Series





BLMQ - Wall Mount Linear

Linear Lighting by



## Certifications and Listings

Certifications that apply to this fixture and its possible configurations are listed here. More information available upon request.

Icon	Description
	Wireless Controls Available
	90 and 95+ CRI Options Available
	120-347V(UN3) Available
	ETL Listed

## Usage Applications

This fixture can be used in a variety of applications, and is ideal for the following:

Usage Application
Grocery Stores
Hospitals
Manufacturing Facilities
Offices
Retail Stores
Schools
Storage Facilities
Surface Mount
Suspended

## Warranty Statement

BJ Take products are tested and/or inspected prior to being packaged for shipment and are guaranteed from the day the product is shipped for a period of ten-year LED chip warranty and a five-year comprehensive component warranty. This can be upgraded to a ten-year comprehensive warranty on request.

# The Quinn Series

BLMQ - Wall Mount Linear

Linear Lighting by **BJTAKE**  
LIGHTING

BLMQ 2' Side

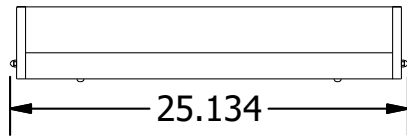

BLMQ End

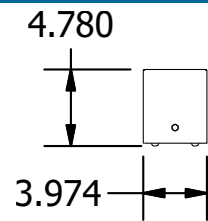

BLMQ 3' Side

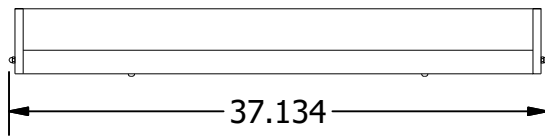

BLMQ End

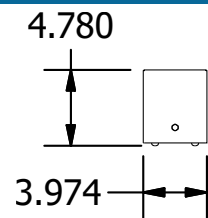

BLMQ 4' Side

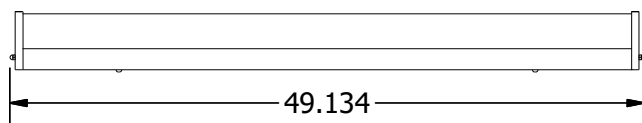

BLMQ End

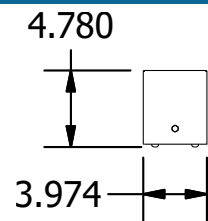

BLR 1x4' Wattage

Length	Lumens	wattage
4'	2.0	21.0
4'	2.5	28.0
4'	3.0	33.0

- \* Drawings aren't to scale
- \* Standard tolerances apply
- \* Specifications may change without notice

BLMQ-4'-4L-4L-840-UNV-L53 UP\_DOWN LIGHT

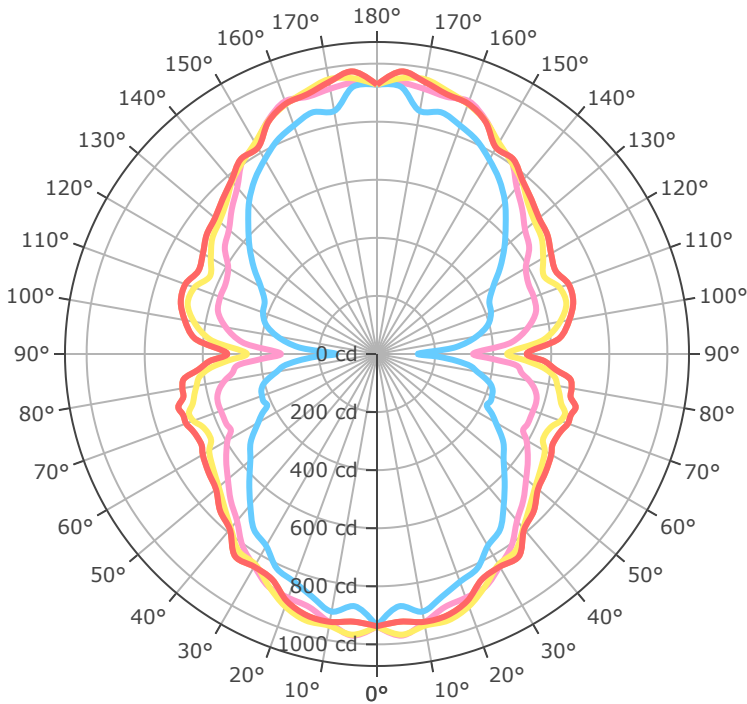

- 0.0°
- 45.0°
- 90.0°
- 135.0°
- 180.0°

Mtg Height	Light Level	Beam Diameter
6.0 ft	26.0 fc	-0.0 ft
8.0 ft	14.7 fc	-0.0 ft
10.0 ft	9.4 fc	-0.0 ft
12.0 ft	6.5 fc	-0.0 ft
14.0 ft	4.8 fc	-0.0 ft
16.0 ft	3.7 fc	-0.0 ft
24.0 ft	1.6 fc	-0.0 ft
32.0 ft	0.9 fc	-0.0 ft
40.0 ft	0.6 fc	-0.0 ft
48.0 ft	0.4 fc	-0.0 ft
56.0 ft	0.3 fc	-0.0 ft
64.0 ft	0.2 fc	-0.0 ft

Emergency Battery Plan - 10W

Emergency Lighting	Solution System Components	System Operation
Option Code 'B17' - UL 924 listed components that are factory installed in the luminaire	UL 924 listed 10-watt battery integral to the luminaire	Loss of normal power is detected by the B17 emergency light solution and the power supply is switched automatically to the 10-watt integral battery pack which powers the emergency LED lighting driver.
	UL 924 listed LED emergency lighting driver integral to the luminaire	The battery pack and emergency LED driver are UL 924 certified to provide a minimum of 90-minutes of emergency lighting.
	Wiring options for both switched and unswitched emergency lighting	

Emergency Lighting Wiring

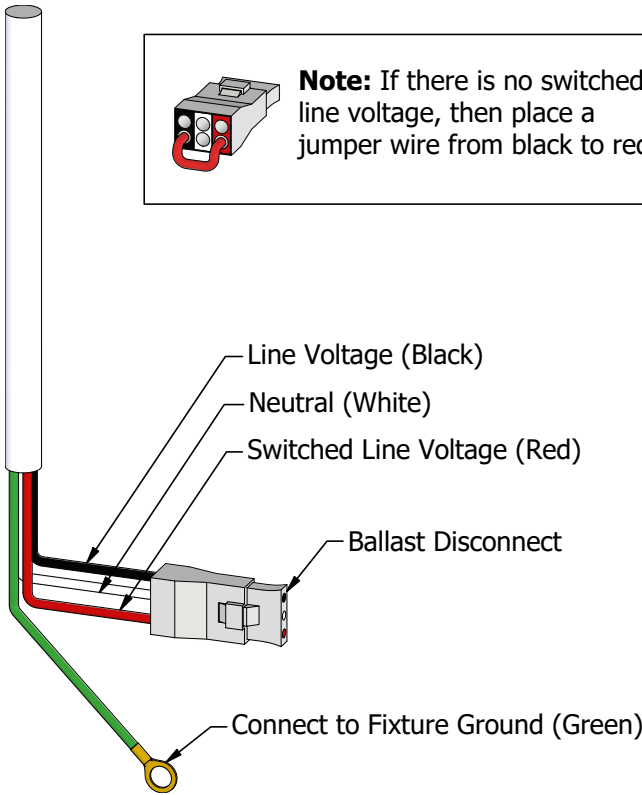
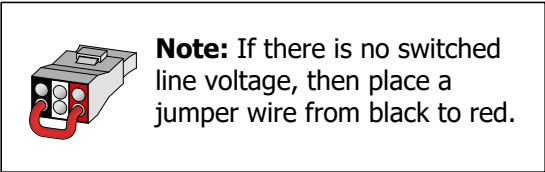

Important Information

More information on emergency lighting options and configurations available on request.

# The Quinn Series

BLMQ - Wall Mount Linear

Linear Lighting by **BJTAKE**  
LIGHTING

## Gallery Information

Below you will find images of relevant products and configurations for the BLMQ.

